



Model 1496S

Micro Mist Full Automatic Computerized Hair Steamer Operation Manual



Thank you very much for your patronage!
Please read the operation manual carefully before you use the product.

Please note: The operation and use functioning of both floor type machines and wall type machines are identical.

■ Please keep the operation manual in a safe place near the product, so you can conveniently look up safety instructions and important information in the future. The operation manual is a part of the product, please do not pass on separately.

1 PRODUCT CHARACTERISTIC

Micro Mist Computerized Hair Steamer will diffuse anion when it's working. The anion can decrease drying phenomenon of curly hair and hair, neutralize the positive charge of curly hair and loosing hair, clear away the inactivity particle in the air. In the course of using the machine, it will send out peculiar smell which without any effect to the human body. Please don't worry and rest assured to use.

ANION CHARACTERISTIC

The using effect is different from the traditional products, as the characteristic is that the wind system of anion will decompose and neutralize with the cation of human hair to decrease hair's static electricity, let the moisture permeate to the hair core, speed up to shape a hair moisture protective layer to keep the nutrition and moisture inside the hair, make the hair meek and not dry, let the hair elegantly, glossy, bright beautiful and easy to carding, also has the health care function for the hair. This is the most popular hairdressing tool to the modern hairdressers.

Electrical Parameter

110-120V ~ 50/60Hz 1300W □

2 CONTROL PANEL

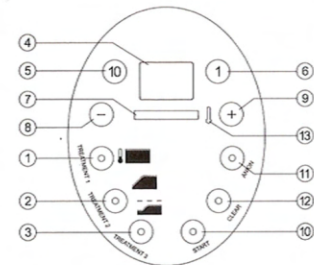

- 1 Treatment 1 Program Selection Key**
Press this key to choose Treatment 1 Program, the build-in working time is 10 minutes and at the Level 4 temperature.
- 2 Treatment 2 Program Selection Key**
Press this key to choose Treatment 2 Program, the build-in working time is 20 minutes and at the Level 4 temperature.
- 3 Treatment 3 Program Selection Key**
Press this key to choose Treatment 3 Program, the build-in working time is 30 minutes and at the Level 3 temperature.
- 4 Time Digital Display**
It displays the working time, the unit is minute, the longest set time can be up to 60 minutes.
- 5 Time Increase Key 1**
Press it one time, Time Digital Display increases 10 minutes; if the display time is 60 minutes, you continue to press this key, then Time Digital Display will become 10 minutes, and it will analogize in this way.
- 6 Time Increase Key 2**
Press it one time, Time Digital Display increases 1 minute; if the display time is 60 minutes, you continue to press this key, then Time Digital Display will become 1 minute, and it will analogize in this way.
- 7 Temperature display**
Altogether it has 5 temperature levels.
- 8 Temperature Level Adjustment Key -**
This key is used for the attenuation and adjusting temperature. Press it one time, it will lower one temperature level.
- 9 Temperature Level Adjustment Key +**
This key is used for the attenuation and adjusting temperature. Press it one time, it will raise one temperature level.

- 10 Start Key**
Press this key to start the work of every programs.
- 11 Anion On/Off Key**
Press this key, the indicating lamp lights up --- Start the anion function.
Press this key again, the indicating lamp extinguish --- Close the anion function.
- 12 Clear Key**
If you need to change the set program, regardless after or before working, only after you press this key, you can change it. After finishing a working program, only after you press this key, you can rechoose the program and begin another working program.
- 13 Heating Indicating lamp**
If the lamp lights, it shows the machine is at the heating condition.

3 OPERATION INSTRUCTIONS

1. Before using, please make sure that the service voltage is the same as the product rating voltage.
2. Add water (please do as Figure 1 and Figure 2)
 - Open the machine Swiveling Lid and take out the Add Water Bottle
 - Add distilled water or similar pure water in the Add Water Bottle, and the water cannot be higher than the Max Water Line.
 - After adding water, please make sure that the Sealing Rings are placed in the appropriate position, then you can close the Add Water Bottle Lid.
 - Along the Guideway, insert the Add Water Bottle in the machine.

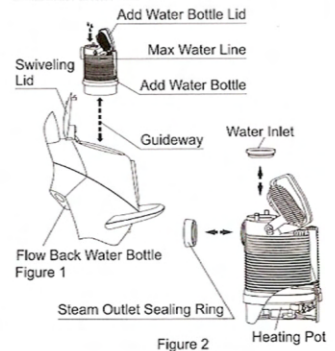
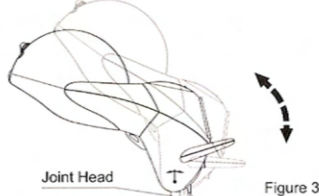

Figure 2 Heating Pot

3. Placement before use

■ Adjustment of helmet angle
To facilitate different customers, by holding the Joint Head in Figure 3, you can incline this appliance up to 20 degrees without limit times.



■ Adjustment of machine height
Loose the Adjusting Handle, set the machine to a needed height, then tighten the Adjusting Handle again.

■ Use by a customer (please see Figure 4)
Lay the machine centrally above the forehead / nape of neck, then the Steam Dome completely covers the customer's hair.
The face and eyes must be outside the steam dome. The helmet turn-knob can revolve freely and smoothly and control the steam out quantity.

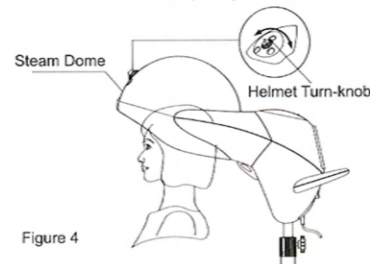

4. Turns on the power switch:

■ After you turn on the power switch, the anion key lamp and the Level 4 temperature lamp will light, Time Digital Display (nixietube) displays 0.

■ After you turn on the power switch, if Time Digital Display (nixietube) displays "[]", it hints the customer that the machine Swiveling Lid is not closed properly, the machine cannot work normally.

■ After you turn on the power switch, if the machine cannot heat up, after 4 minutes, the machine alarm sounds, it shows that there is no water in the Add Water Bottle, then please the customer to add water.

5. Choose the working program:

■ Choose the different working program according to the customer's need, altogether it has 3 treatment working programs.

■ If the customer wants to adjust the working time, press Time Increase Key 1 one time, Time Digital Display increases 10 minutes; Press Time Increase Key 2 one time, Time Digital Display increases 1 minute.

■ If the customer wants to adjust the working temperature, press Temperature Level Adjustment Key - one time, it will lower one temperature level; Press Temperature Level Adjustment Key+ one time, it will raise one temperature level.

6. Change the working program setting before working:
■ After the customer chooses the working program or adjusts the working time and/or temperature, even the machine has not started to work, he still needs to press Clear Key, then he can do his change.

7. During operation:

■ During operation, Time Digital Display shows the remaining time, time decimal point blinks at the frequency of once per second.

■ During operation, if there is no water in the Add Water Bottle, the machine will stop heating. When the temperature inside the helmet is lower than 100° the alarm apparatus will sound.

■ During operation, if you lift the swiveling lid, the machine will stop heating. Only after you close the swiveling lid, then the machine can continue to heat up.

■ During operation, when working time remains 3 minutes, Time Digital Display will light.

8. Change the working program during operation:

■ To change the working program during operation, you must first press the Clear key. After the machine stops working, rechoose the working program.

■ During operation, you can change time and temperature.

9. Finish the work:

■ After finishing the work, Time Digital Display shows "0", the time electronic alarm sounds, it will stop spray and atomization.

■ After finishing every working program, please empty the water in the Flow Back Water Bottle. Please refer to Figure 5 for taking out and installing the Flow Back Water Bottle.

10. Turn off the power source:

■ To make the machine work better, please turn off the power within 5 minutes after the chosen mode finishes operation.

■ This machine doesn't have memory function, therefore after turning off the power source, all settings will disappear and become invalid.

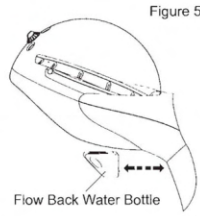

4 EXTRA LARGE HELMET

Large 12" Inside Diameter

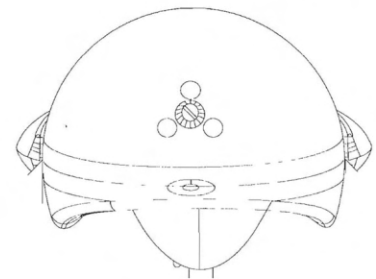

10" deep



5 STAND INSTALLATIONS INSTRUCTION AND PARTS LIST

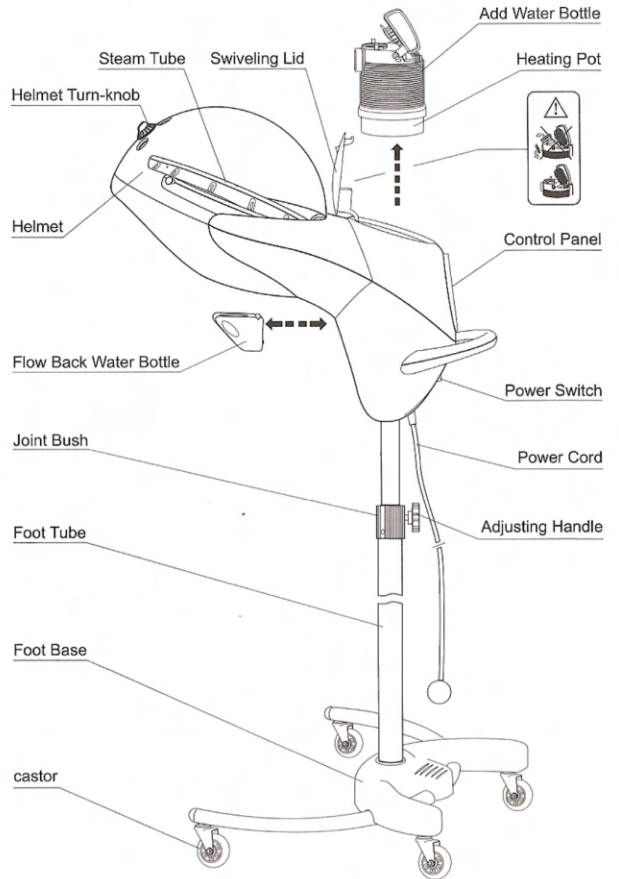

6 MAINTENANCE

Before cleaning, please remove the power cord.

1. The assembly inside the helmet is easily to taint dirt and get dirty, please clean it regularly. Chemical articles, such as hair dye and so on, can induce abnormal function.
2. Use a dry soft cloth to wipe and clean it. If water splashes on the control board, use a dry cloth immediately to wipe away the water, otherwise it will induce machine abnormal function.

⚠ ATTENTION:

Please do not use the following matter: thinner, alcohol, gas, coal oil or other volatilizable chemical; corrosive wax or sponge and so on.

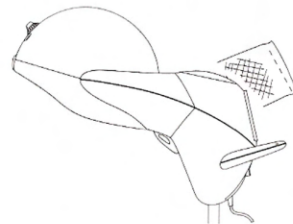

7 CAUTIONS

1. Before using, please make sure that the service voltage is the same as the product rating voltage.
2. Operating environment: an ambient temperature of 5°C to 40°C; a relative humidity less than 95%.
3. To ensure users' safety, never insert miscellany into the machine, especially metal objects.
4. To prevent causing electric shock, be sure not to use it near flammable gas, objects or use it under similar environments.
5. After switching on power, if you find any abnormal condition, please send to maintenance departments or have it repaired by professionals. Don't disassemble or repair it by yourself.
6. Don't remove the plug by pulling the cable. Please hold the plug and then pull. Do not move the product by pulling the power cord or grabbing the machine hood. It is strictly prohibited to use it outdoor or outside.
7. It is strictly prohibited to compulsively curve, stretch or bump the power cord. If the cable is damaged, in order to avoid danger, it should be replaced by the manufactory, the maintenance department or similar professionals.
8. Use only distilled-purified water; do not use tap water. Don't add such as toning lotion, perfume and so on, otherwise that will induce function abnormality or skin allergy.
9. Children should be supervised to ensure they won't play with it.
10. This apparatus is not prepared for use by people who have weak, infirm physical abilities, or who have slow, tardy reaction or response, or who have mental, spirit handicap, impediment or psychotic (including children), unless they can safely use it under the instructions and help from personnel who have safe responsibilities to them.